

D. JOSÉ MARIA CUADRADO  
VIGA ARMADA 1:5  
para la  
Escalera  
pintado 16-3-06

cartelas de 10%  
pernaches de 19%

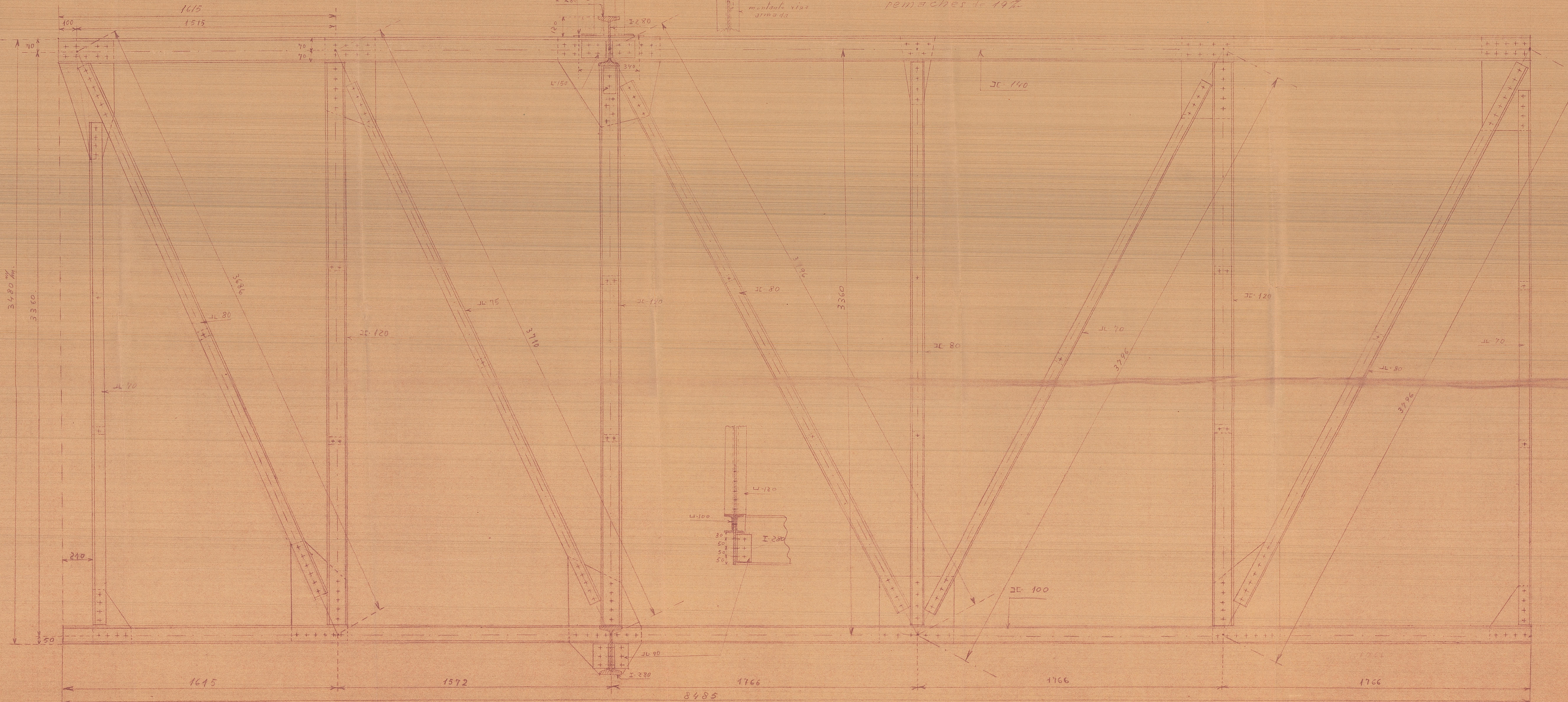
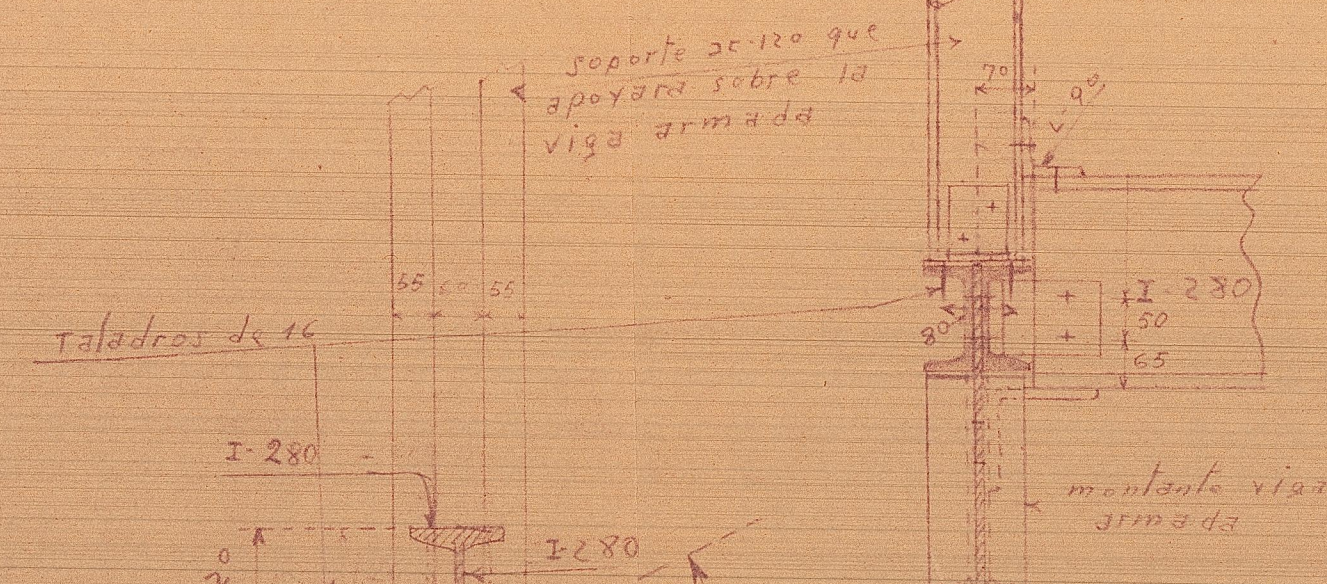

3480 mm  
3360

1615  
1515

I-280  
I-280

IC-140

3360

3796

3710

3796

1615

1572

8485

1766

1766

1766