

CIMENTOS.

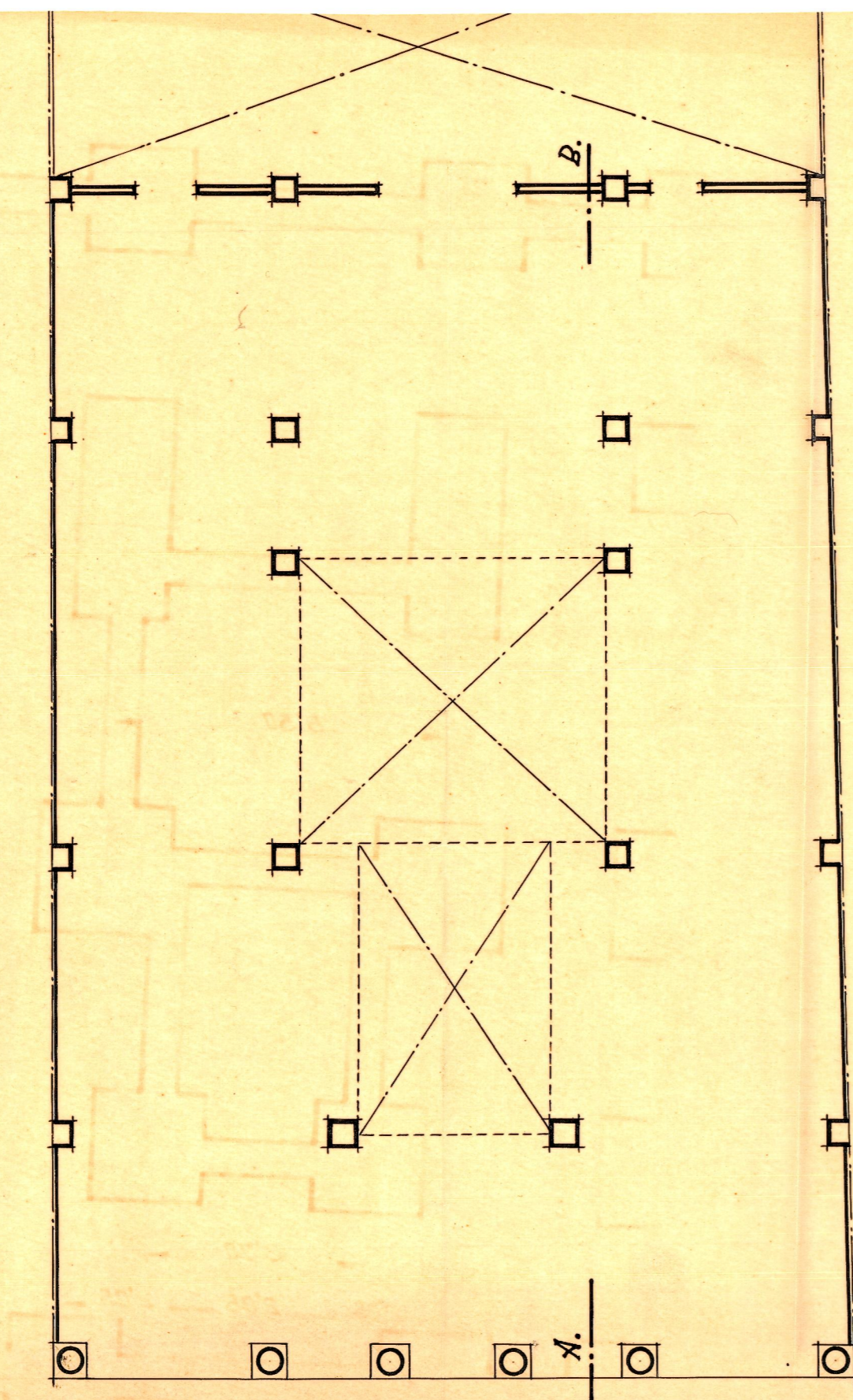

Calle Guillen de Castro n.º 63.
PLANTA BAJA.

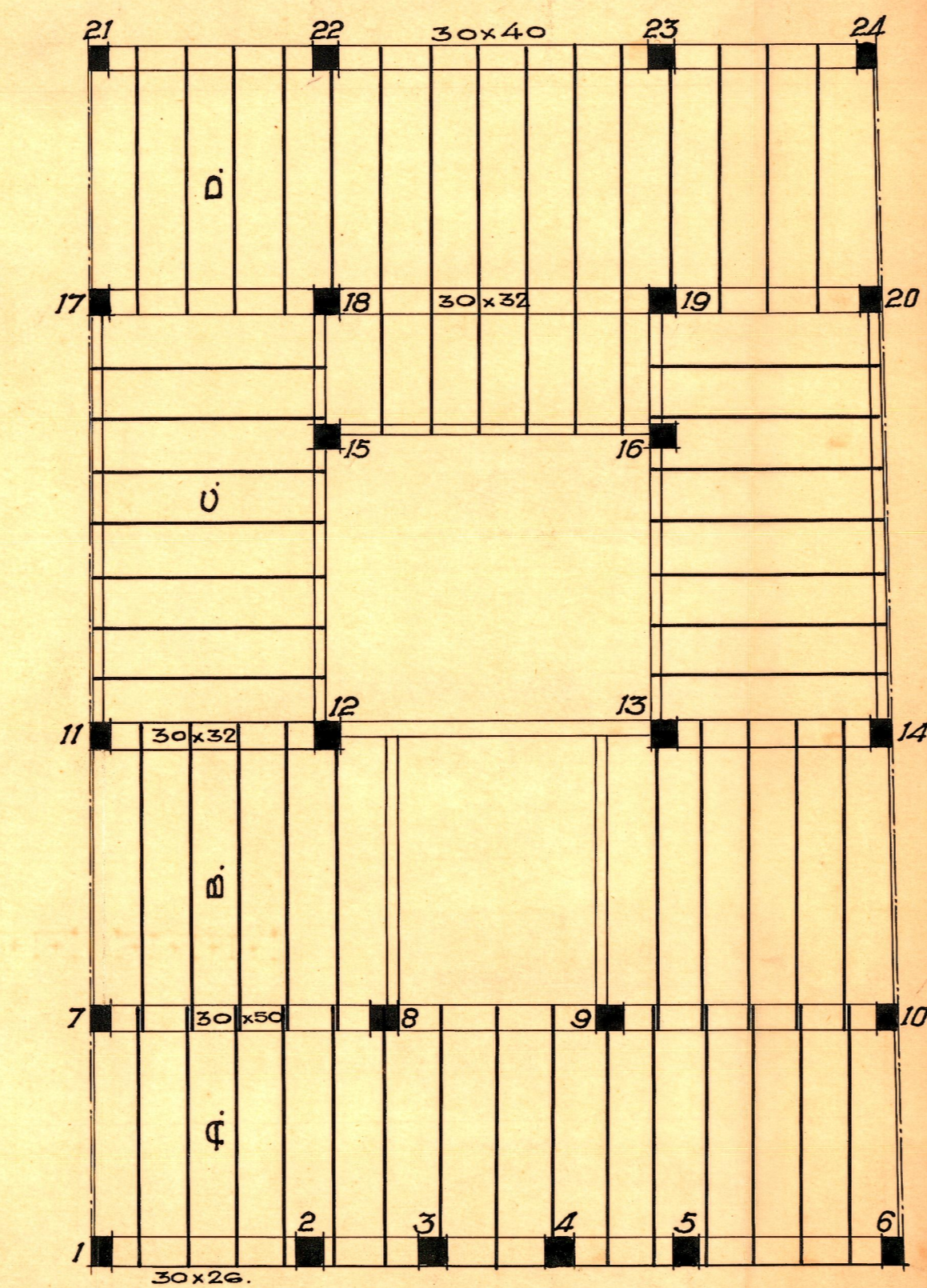

ESTRUCTURA.

EMPLAZAMIENTO.
ESCALA 1/4.000.

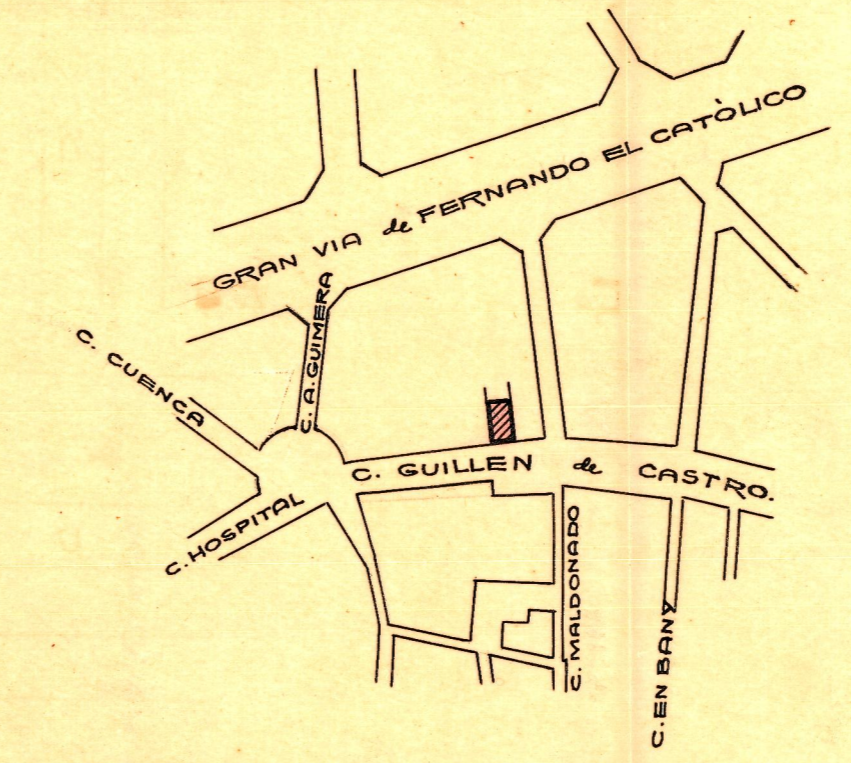

ESCALA 1/100.
Valencia-Dibne-1946.
El Arquitecto:

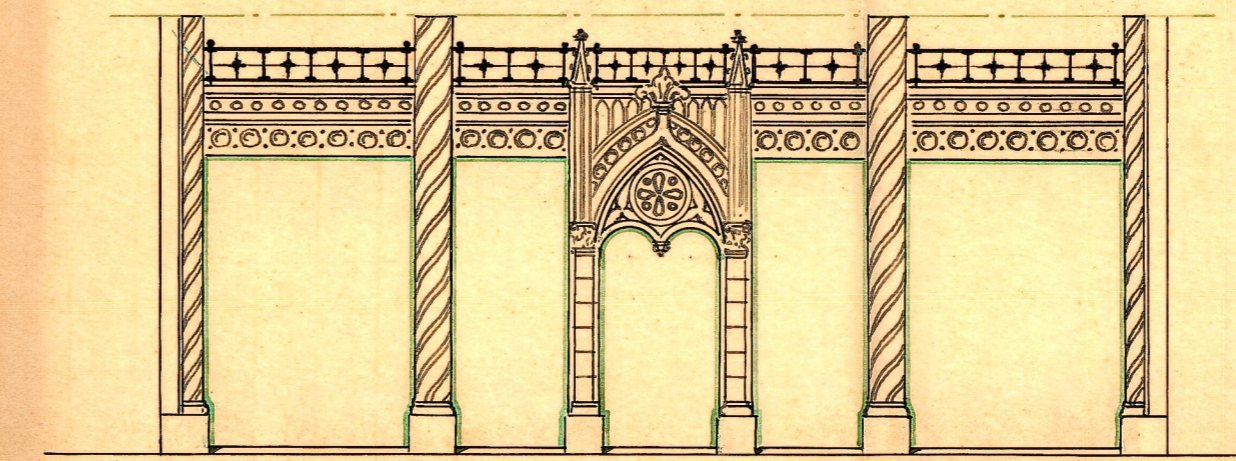

FACHADA.

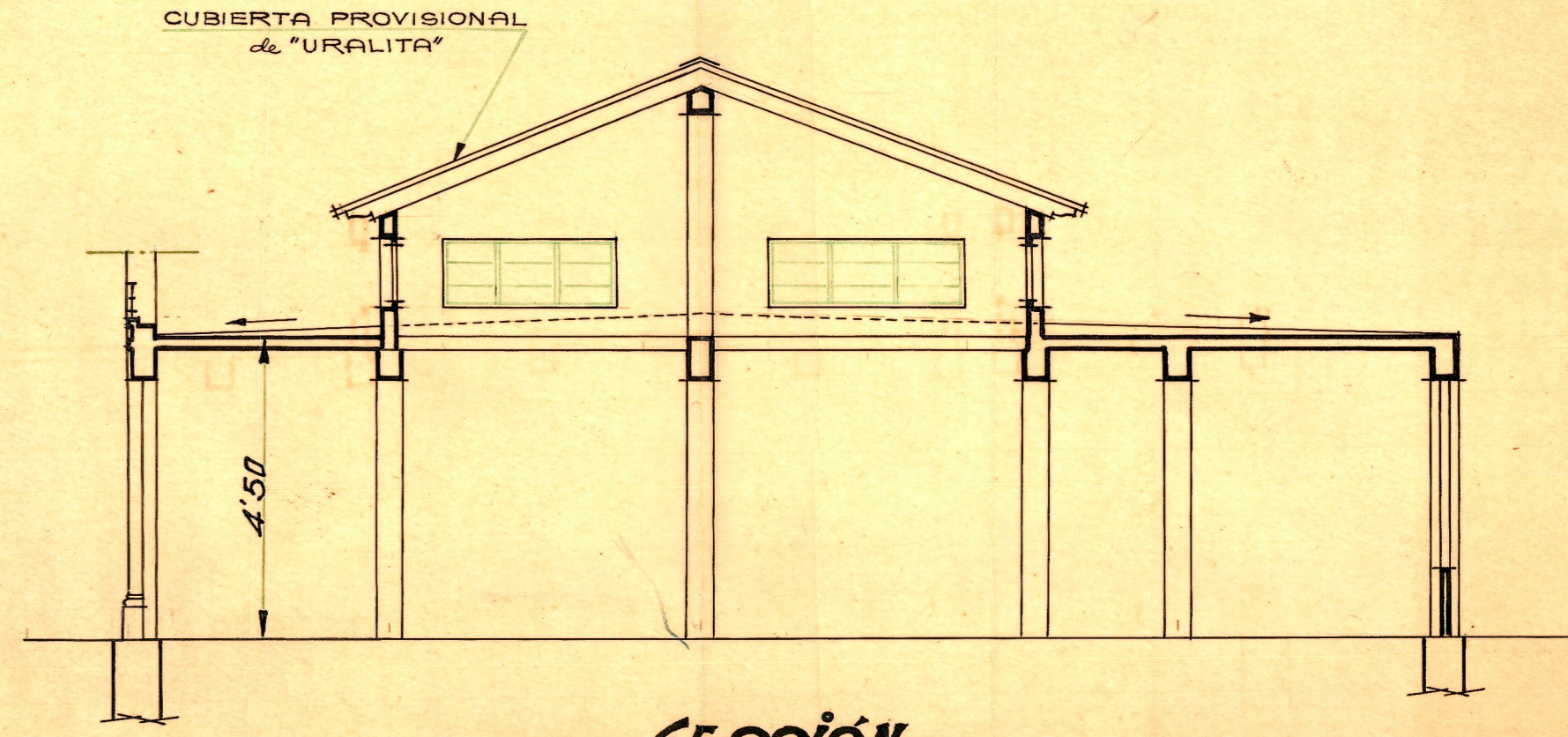

SECCIÓN.
por A.B.