



$$\textcircled{A} = \frac{1}{2} \times 5'00 \times 1'55 = 3'87 \text{ m}^2$$

$$\textcircled{B} = \frac{1}{2} \times 5'00 \times 2'85 = 7'12 \text{ "}$$
$$\underline{10'99 \text{ m}^2}$$

$$10'99 \times 19'49 = 214'19 \text{ palmos}^2$$

D. Mateo Giménez

~~D. X~~
Gregorio Chafre

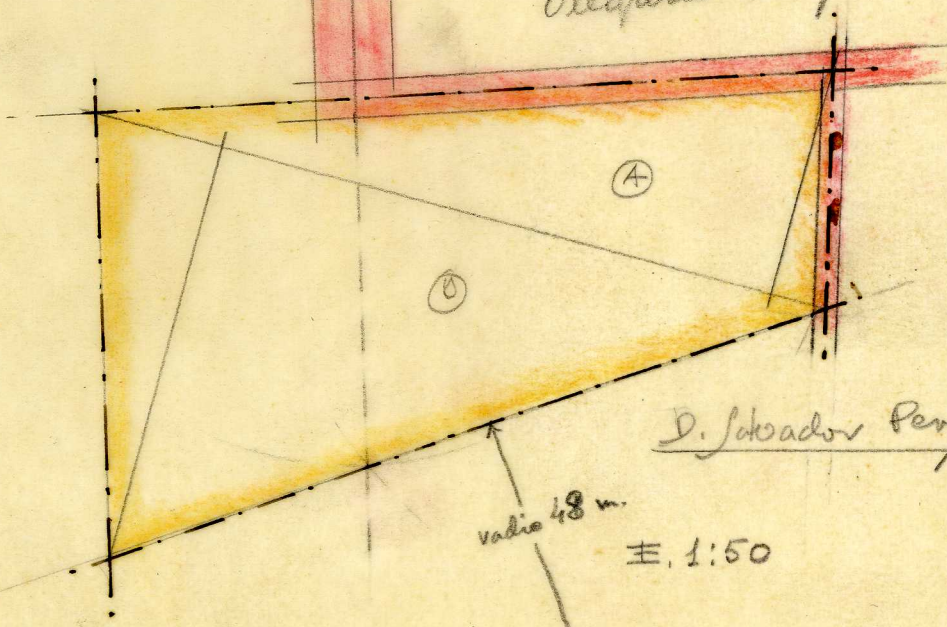

D. Salvador Peris

E. 1:50