

MEDIANERA

St. SANCHO - St. MORTES

LADRILLO

132'53 m² de 0'25m. espesor

33'132 m³ a 200 pt - 662640

HORMIGON

18'80 m² de 0'375m. espesor

6'900 m³ a 120 pt - 828 pt.

E. 1:100

fr Sancho
Valencia

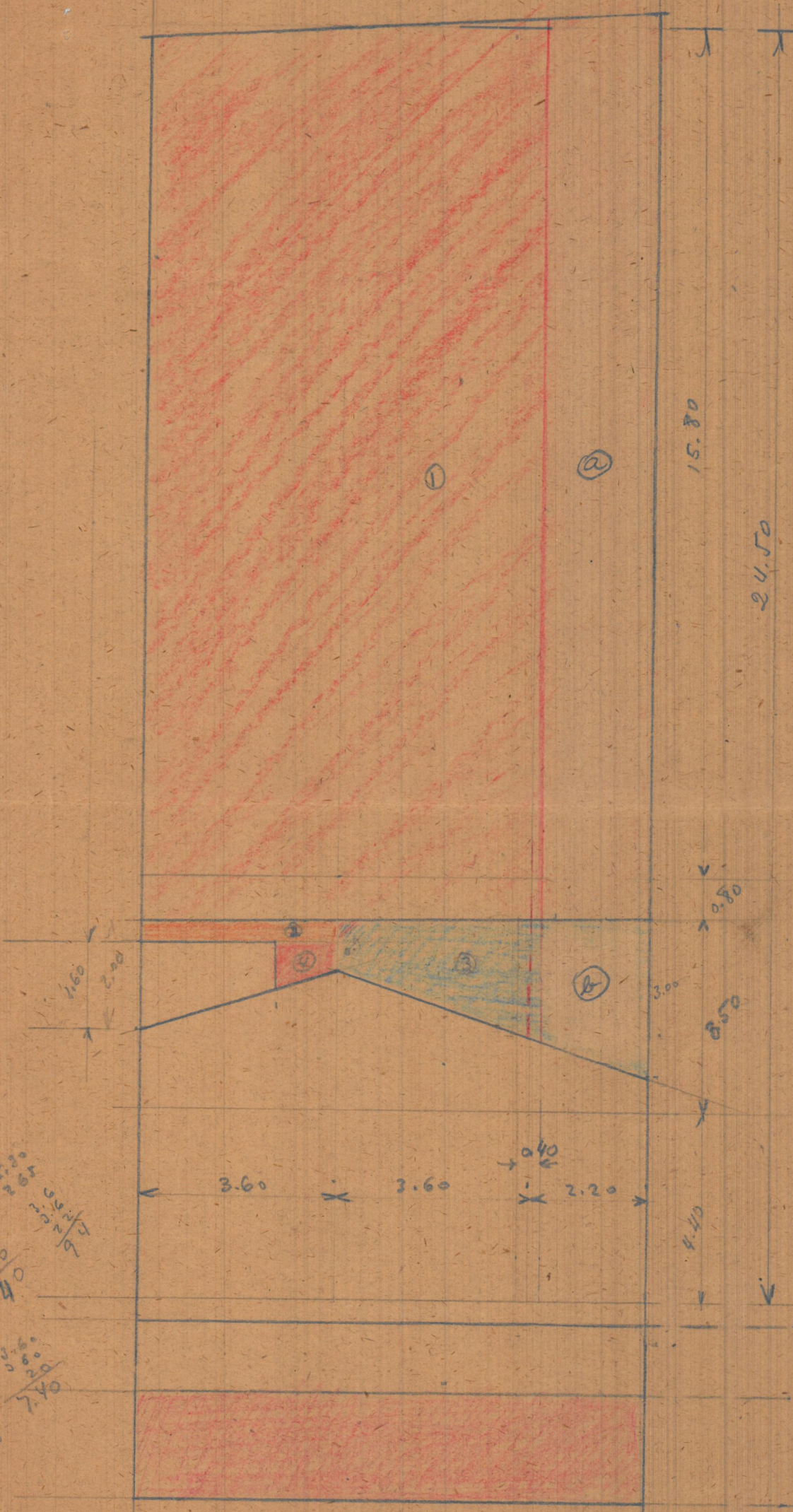

Patio
 ② 16.60 x 2 = 33.20 m²
 ④ 2.65 x 2 = 5.30 m²
 38.50 m²

Mediavues

① sup 16.60 x 7.40 = 122.84 m²
 ② " 3.60 x 0.40 = 1.44 "
 ③ " 1.95 x 3.80 = 7.41 "
 ④ " 0.7 x 1.20 = 0.84
 132.53 m²
 38.50
 171.03

171.03 = 171.03
 171.03 = 171.03
 171.03

Limietos

9.40 x 2 x 37.50 = 708 m³

37.50 Seccion

1.8
2.00

15.80
37.50
37.50