

P. el Patido

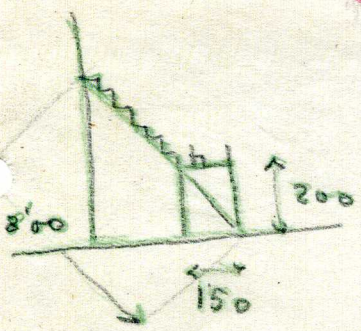
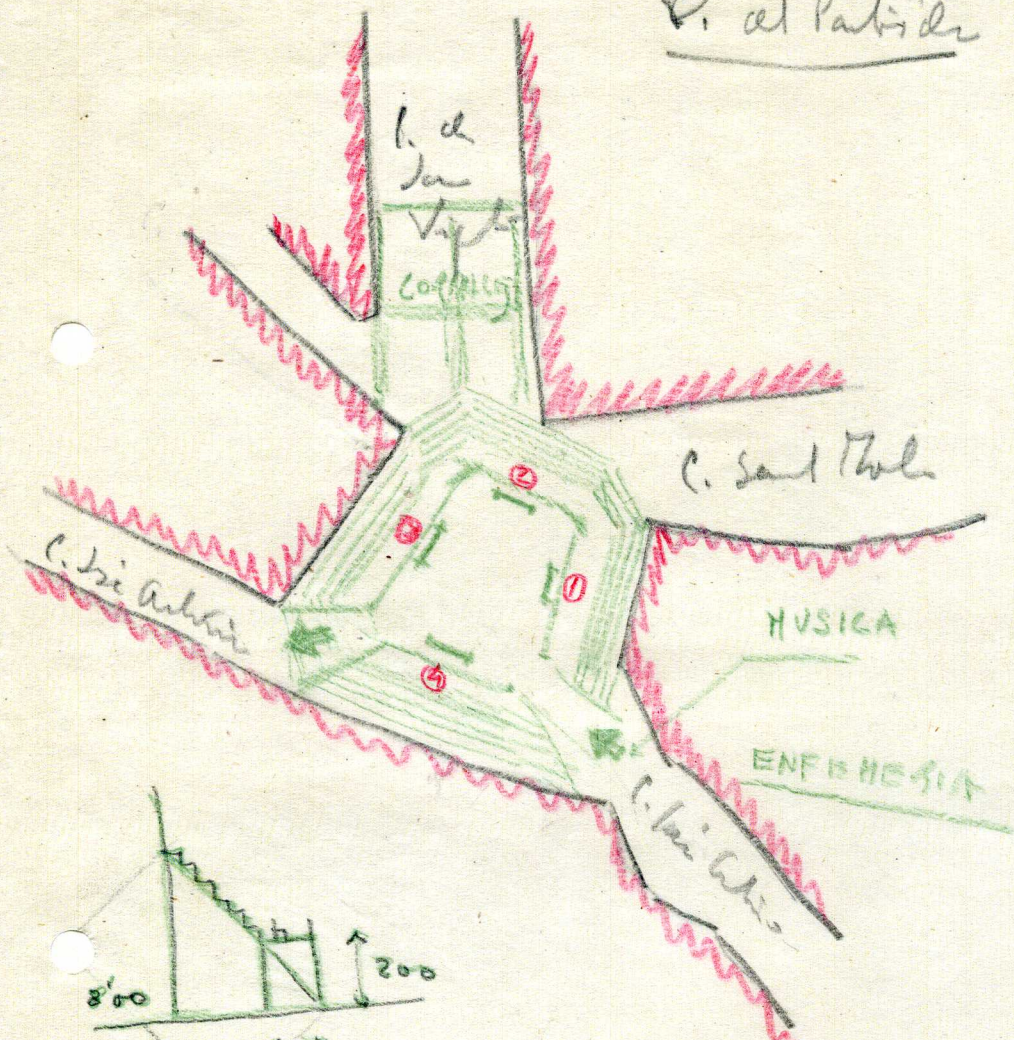

SILLAS = 120
ASIENTOS = ① - $18 \times 2 \times 2 = 72$ asientos
 ② - $16 \times 8 \times 2 = 256$ "
 ③ - $18 \times 2 \times 2 = 72$ "
 ④ - $16 \times 10 \times 2 = 320$ "

 720 asientos