

Technical drawing of a fire alarm system. The main component is a control panel with the text "ROMPASE EN CASO DE INCENDIO" (Break in case of fire). The panel is labeled with numbers 1 through 6. A detector is shown in a cross-section view above the panel, also labeled with numbers 1 through 6. The drawing includes a top view of the detector and a side view of the panel.

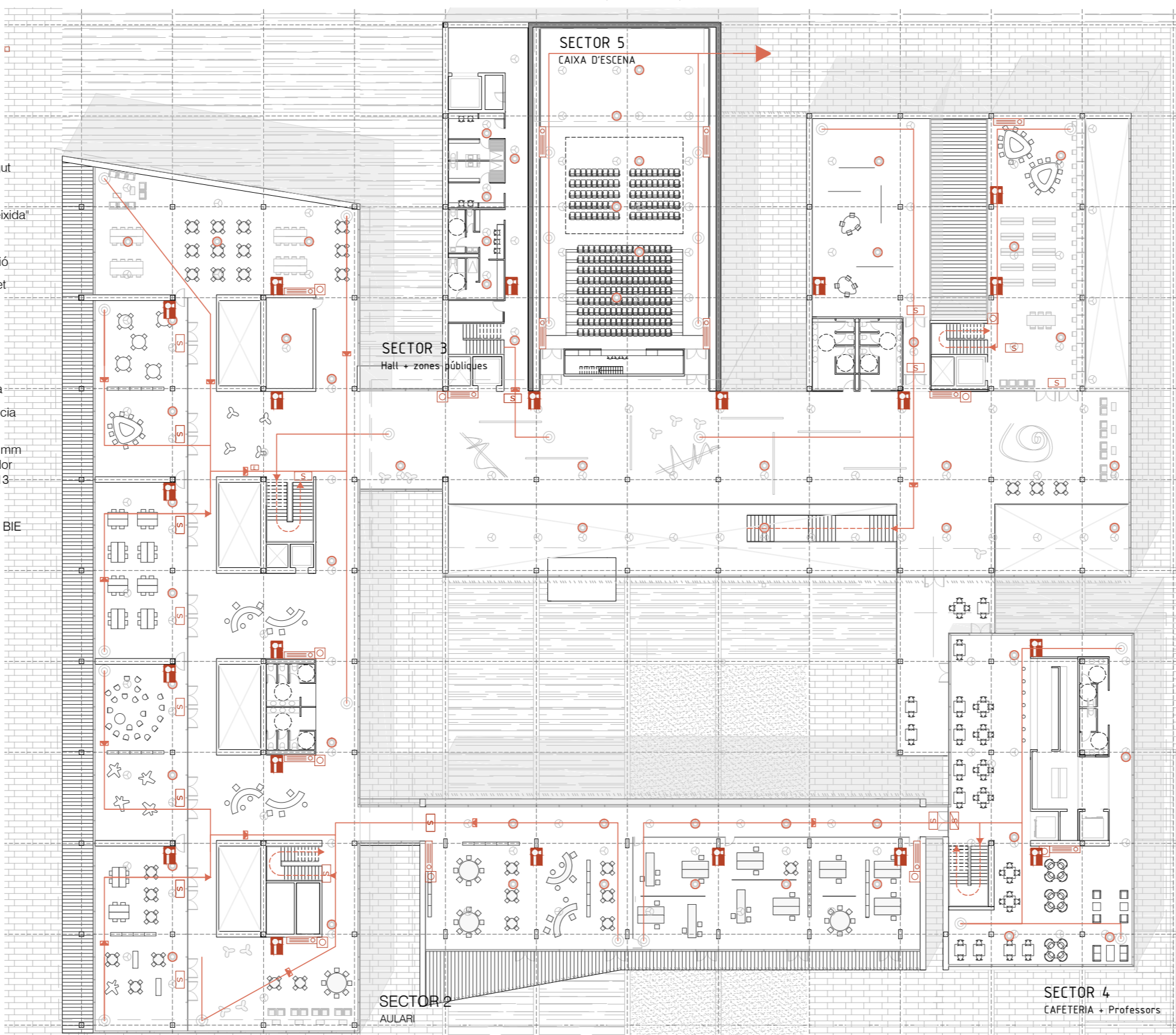

ZONA TIPUS D'ACTIVTAT		Ocupació (m2/persona)
Aules teòriques		1,5 x 70 = 105
Aules laboratoris		5 x 90 = 450
Biblioteca		5 x 400 = 2000
Administratius Zona d'oficines		10 x 540 = 5400
Cafeteria / menjador		
Zona taules		1,5 x 470 = 705
Cuina		10 x 66 = 660
Sala polivalent		
Zona d'espectadors		1 pers / seient = 292
Vestuaris		3 x 95 = 285

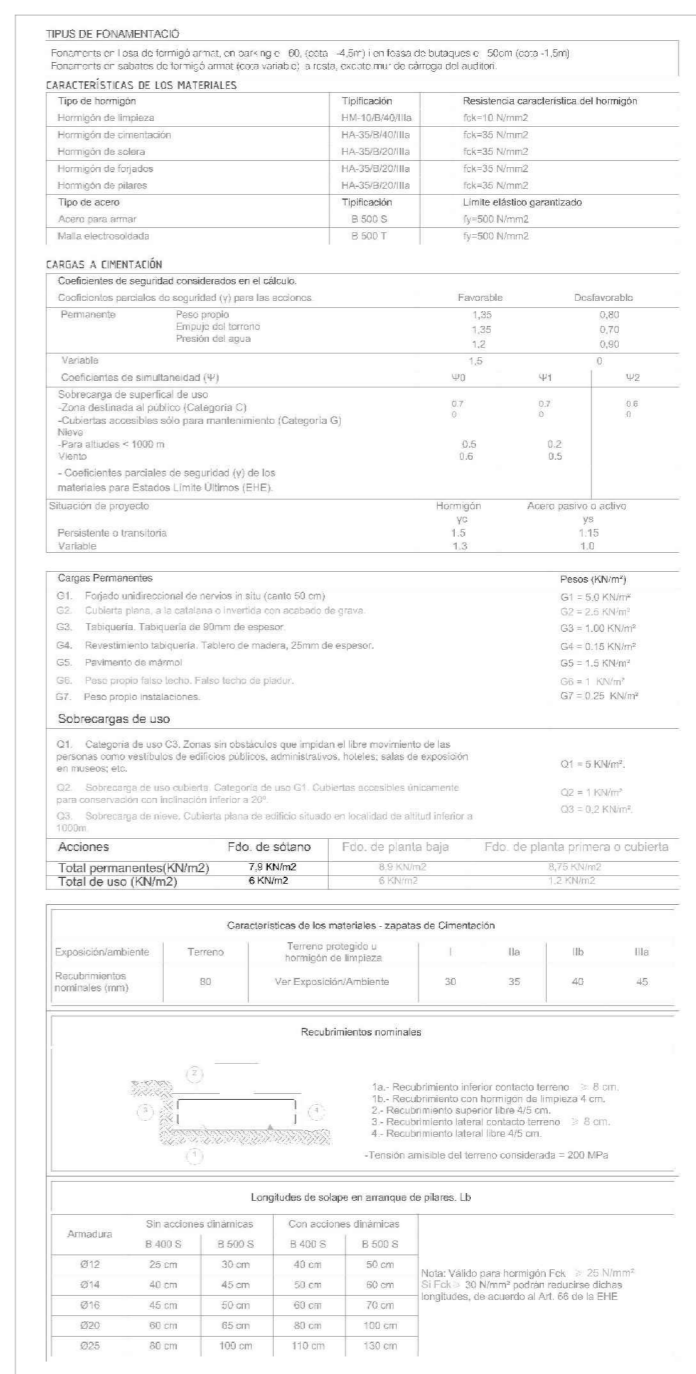
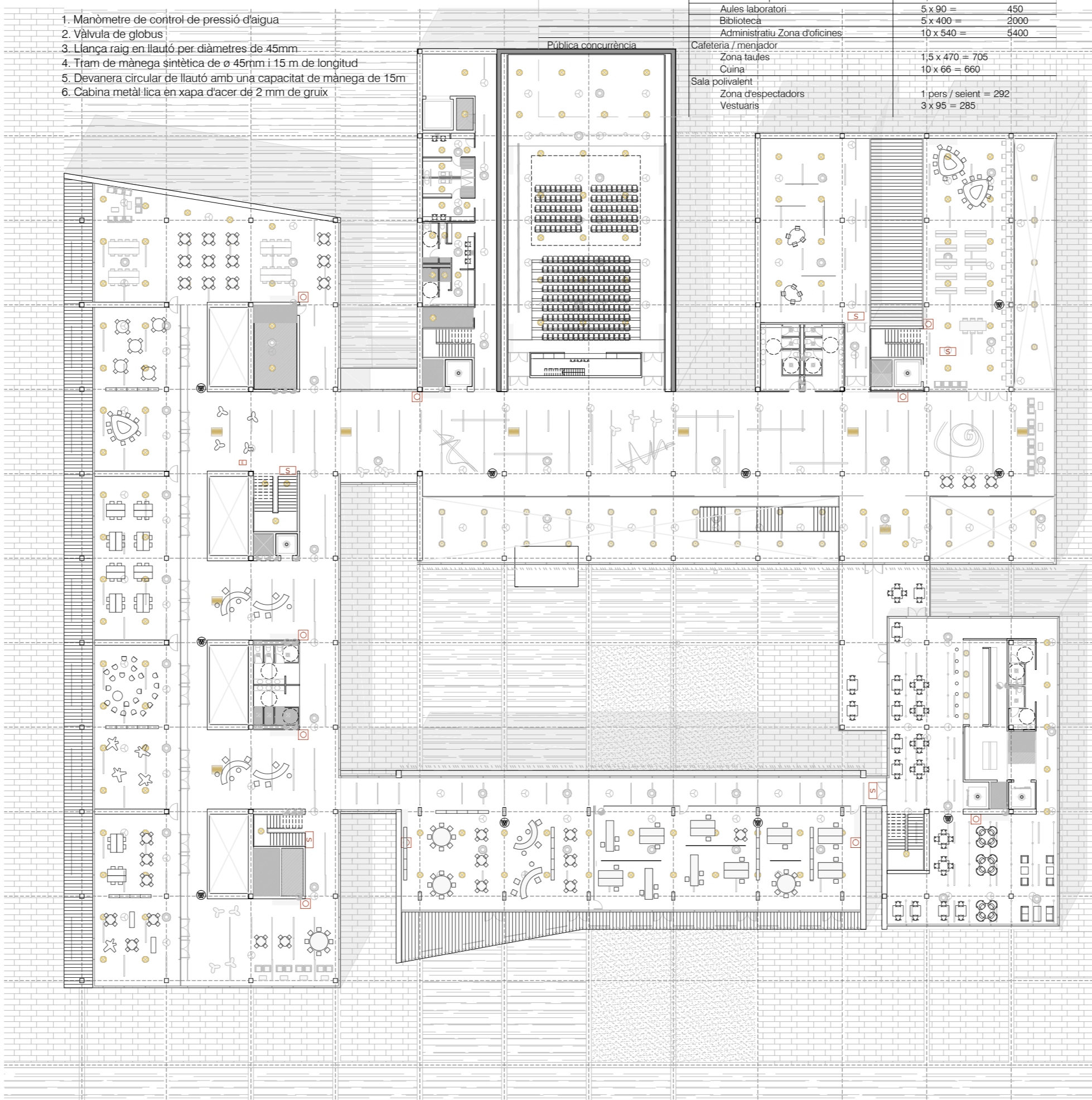

Detall del falç sostre en la zona de les aules

