

Administración de la zona esquina
 de calle del fondo de Tenorio y calle del
 Salvador — D. Luis Martínez — procurador
 de los tribunales y dueño del Estero
 frente a los frutales de Cabañero

PIE DISEÑO DE ORMIGÓN ARMADO

Pt. de 25x25
 a 40 Kp v = 2
 luzes = 25000 Kp

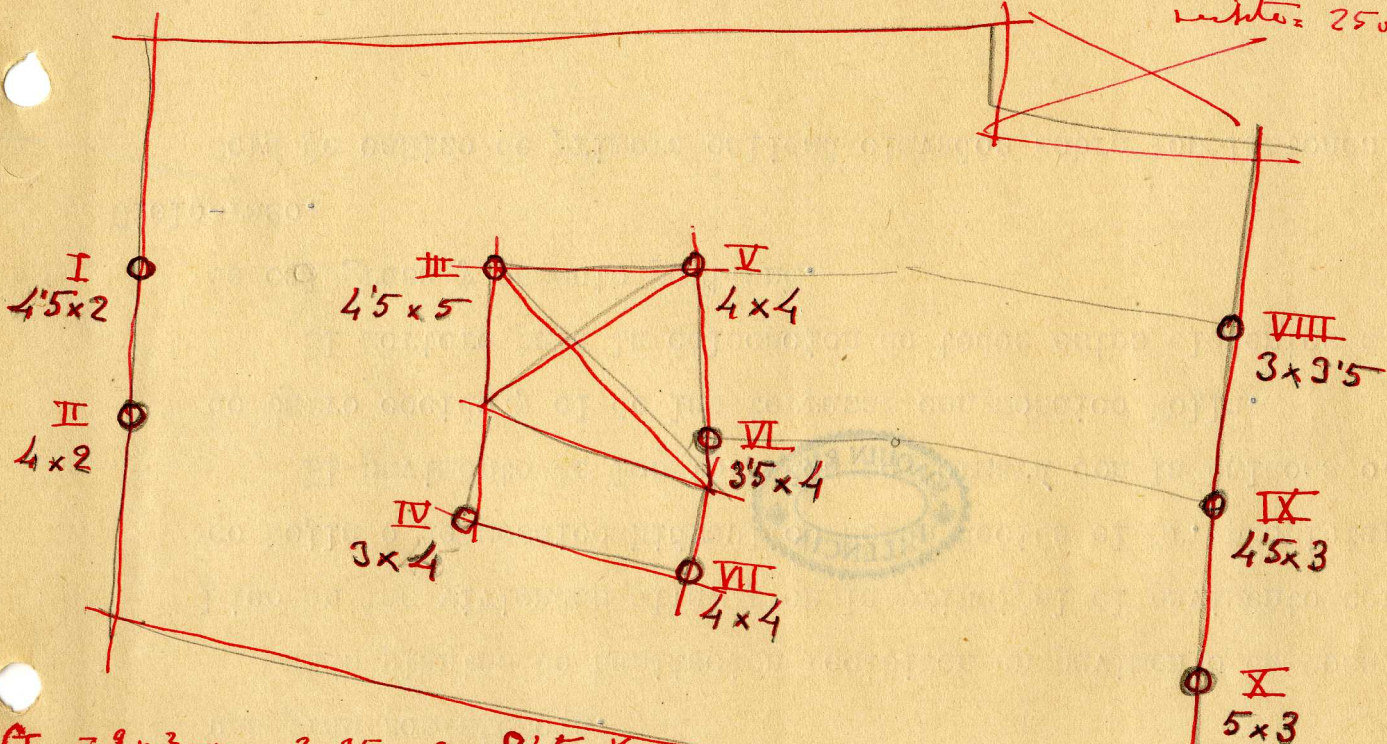

25
 25
 125
 50
 625
 40
 2500

10	I	= 9 m ²	3 x 350 x 9 = 2450 Kp
	II	= 8 "	3 x 350 x 8 = 2400 "
23	III	= 22'5 "	3 x 350 x 22'5 = 23625 "
	IV	= 12 "	3 x 350 x 12 = 12600 "
	V	= 16 "	3 x 350 x 16 = 16800 "
	VI	= 14 "	3 x 350 x 14 = 14700 "
	VII	= 16 "	3 x 350 x 16 = 16800 "
15	VIII	= 10'5 "	3 x 350 x 10'5 = 11025 "
	IX	= 13'5 "	3 x 350 x 13'5 = 14175 "
	X	= 15 "	3 x 350 x 15 = 15750 "

I, II = 10 Ton.
~~III, IV, V, VI, VII~~
 VIII, IX, X = 15 Ton.
 III, V, VI, VII = 16 Ton.
 III = 23 Ton.

350
 3
 1050