

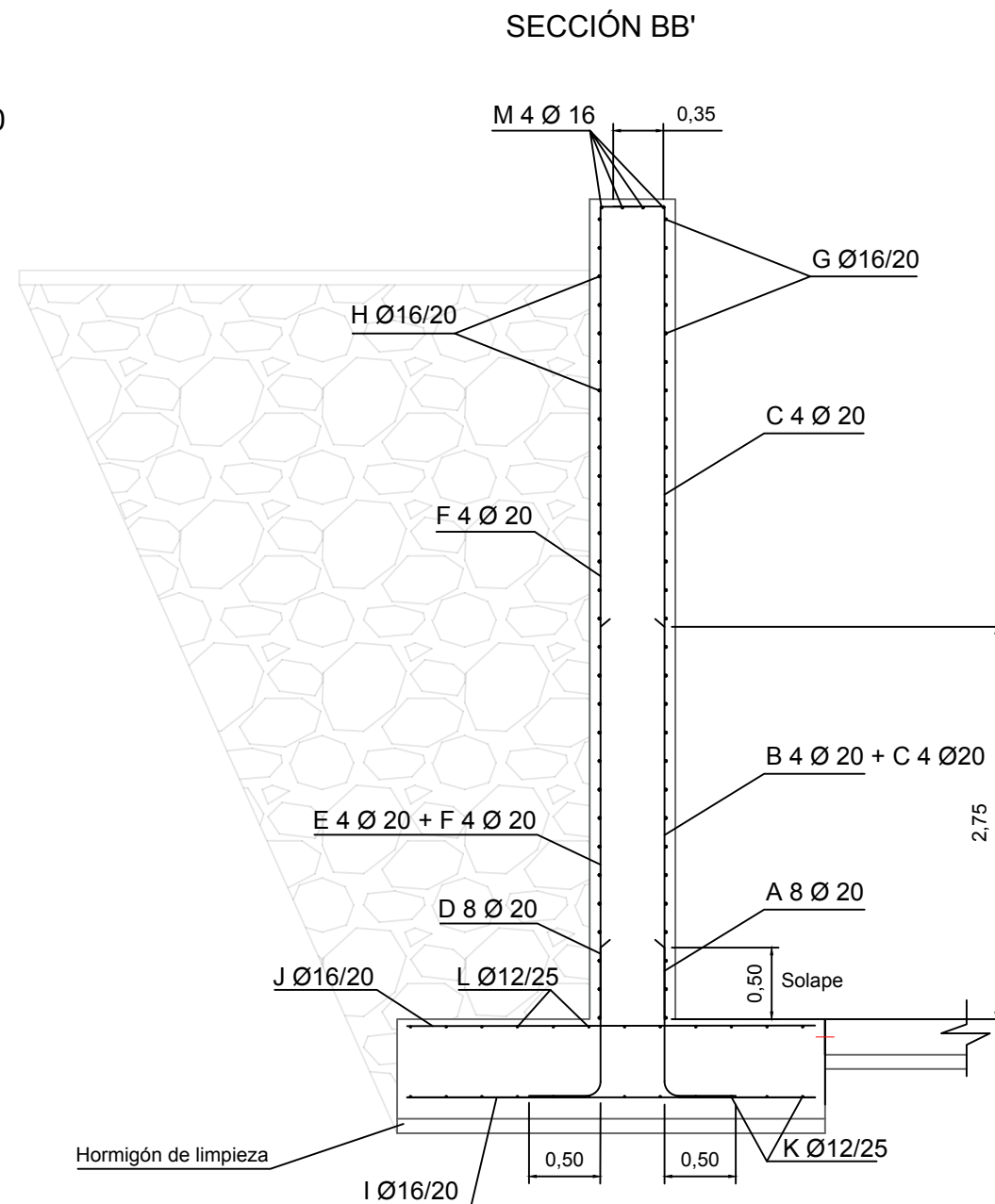

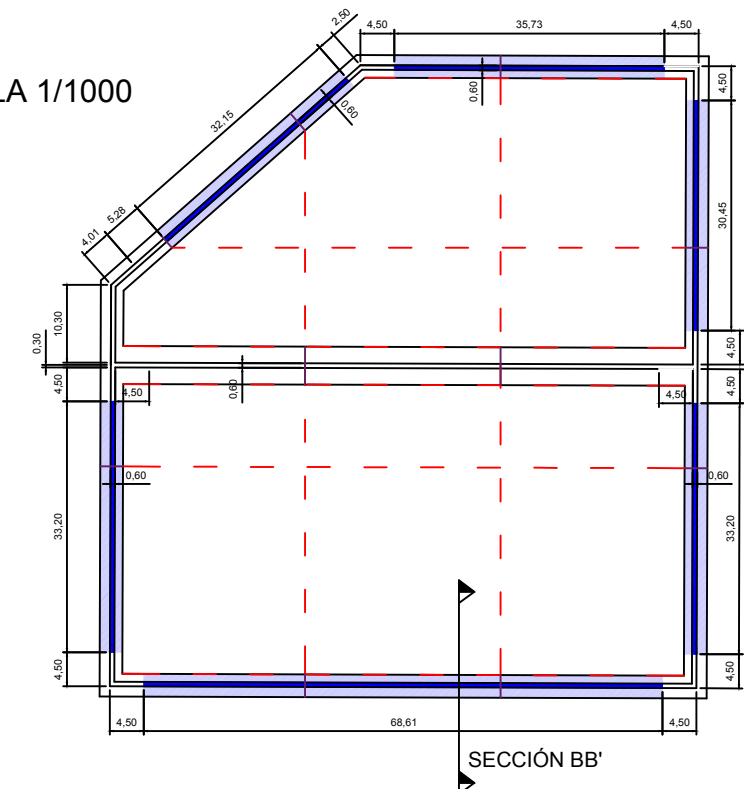











ESCALA 1/50



CUADRO DE CARACTERÍSTICAS					
MATERIAL	DEFINICIÓN		NIVEL DE CONTROL	COEFICIENTE DE SEGURIDAD	REC (mm)
HORMIGÓN	Muros	HA-30/F/20/IV	Estadístico	1,5	50
	Zapata	HA-30/F/20/IV	Estadístico	1,5	50
	Losa	HA-30/F/20/IV	Estadístico	1,5	50
ACERO	Todos los elementos	B500S	Normal	1,15	
EJECUCIÓN	Todos los elementos		Normal	EHE 08	

NOTA: El recubrimiento de los elementos hormigonados directamente contra el terreno será de 70 mm.



DESPIECE ARMADO DE MURO							
ID	D(mm)	FORMA(m)	Nº de piezas	Longitud (m)	Longitud total (m)	Peso (Kg/m)	Peso (Kg)
A	20		8	1,55	12,40	2,47	30,628
B	20		4	2,75	11,00	2,47	27,170
C	20		4	6,05	24,20	2,47	59,774
D	20		8	1,55	12,40	2,47	30,628
E	20		4	2,75	11,00	2,47	27,170
F	20		4	6,05	24,20	2,47	59,774
G	16		29	1,00	29,00	1,58	45,820
H	16		29	1,00	29,00	1,58	45,820
I	16		4	2,85	11,40	1,58	18,012
J	16		4	2,85	11,40	1,58	18,012
K	12		12	1,00	12,00	0,888	10,656
L	12		12	1,00	12,00	0,888	10,656
M	16		4	1,00	4,00	1,58	6,320
					SUMATORIO	390,409	
					Computo de metros totales		232,340
					TOTAL		90707,63