

F.C. Valencia a Liria

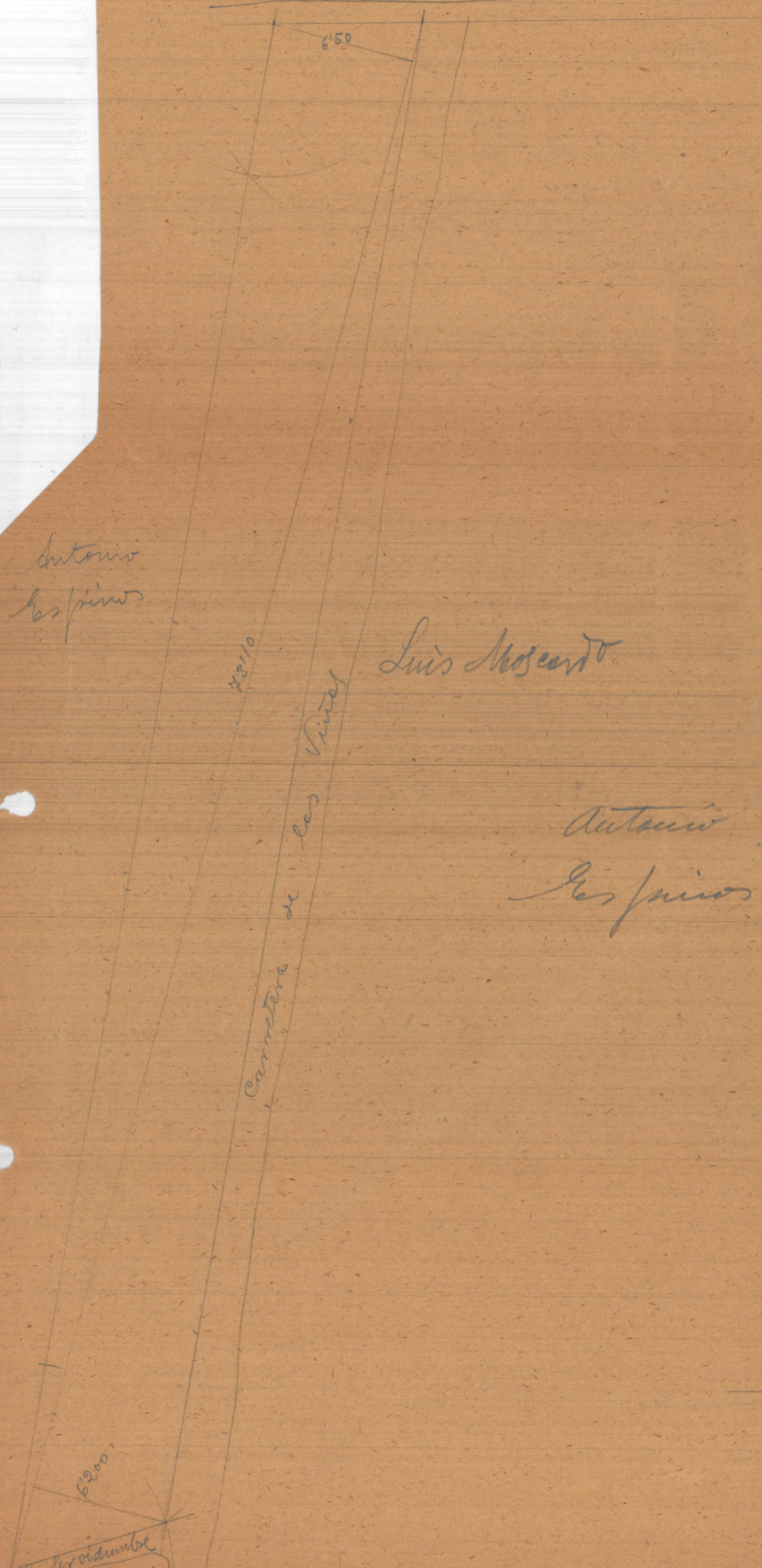

$$\frac{43'10 \times 6'50}{2} = 237'57$$

$$\frac{43'10 \times 6'20}{2} = 226'60$$

$$\frac{237'57 + 226'60}{2} = 464'17 \text{ total m}^2$$

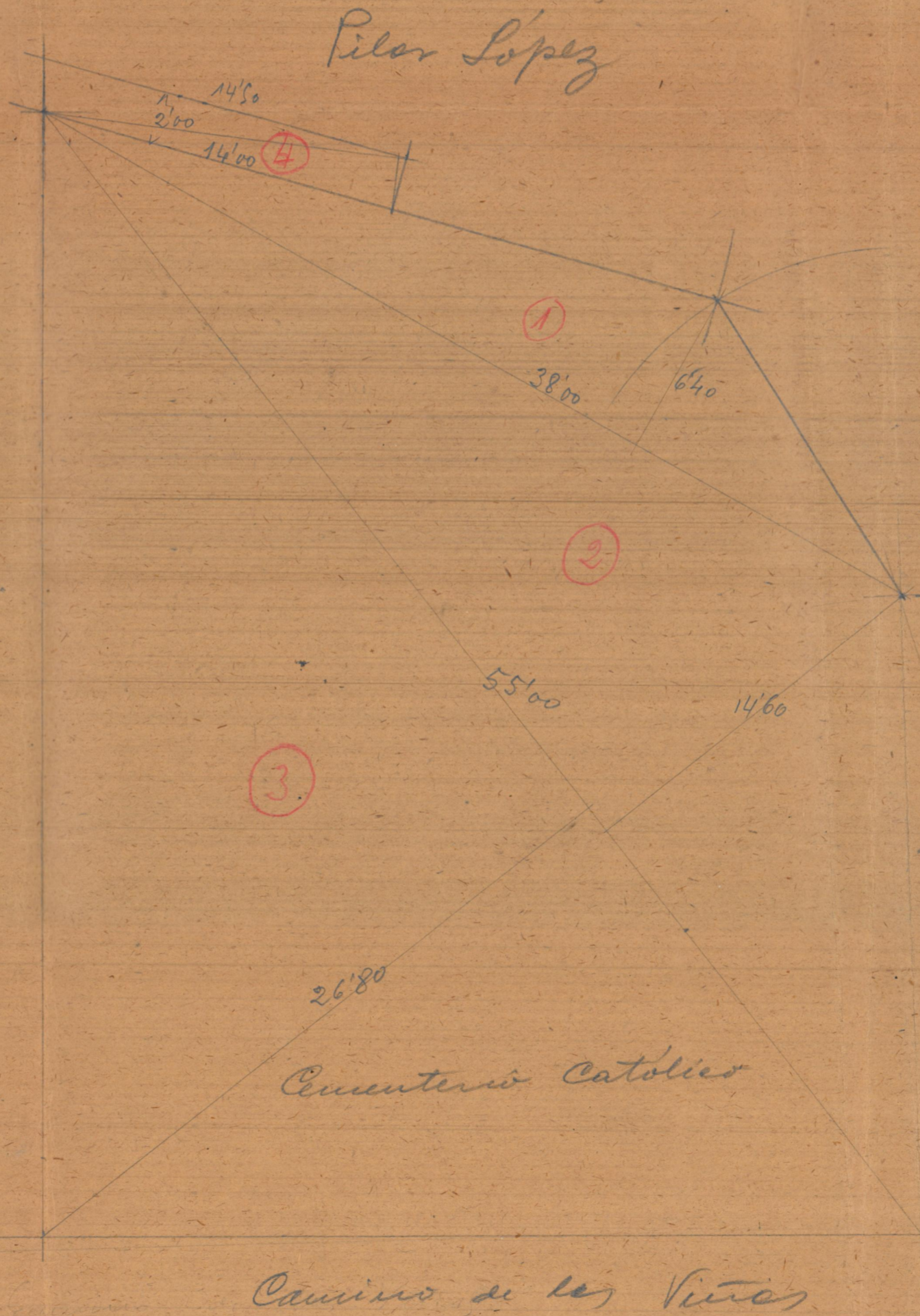

- ①  $\frac{38'00 \times 6'40}{2} = 121'60 \text{ m}^2$
- ②  $\frac{55'00 \times 14'60}{2} = 401'50 \text{ m}^2$
- ③  $\frac{55'00 \times 26'80}{2} = 737'00 \text{ m}^2$
- ④  $\frac{14'50 + 14'00}{2} = 14'25 \times 2'00 = 28'50$

Azogado lindando con la acequia de Mislate.



E. L. 200

Antonio Espino

Camino de las Viñas

Calvario

Antonio Espino

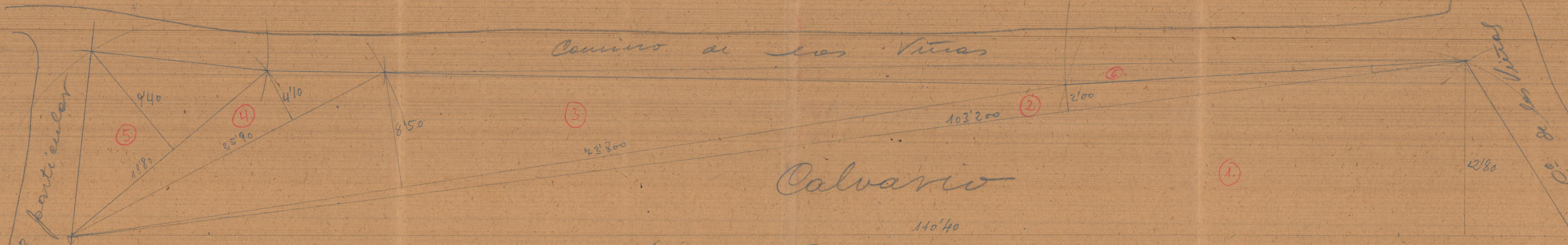

$$\begin{aligned}
 & \textcircled{1} \frac{110'40 \times 12'80}{2} = 706'56 \text{ m}^2 \\
 & \textcircled{2} \frac{103'20 \times 2'00}{2} = 103'20 \text{ m}^2 \\
 & \textcircled{3} \frac{73'80 \times 8'50}{2} = 313'65 \text{ m}^2 \\
 & \textcircled{4} \frac{25'90 \times 4'10}{2} = 53'09 \text{ m}^2 \\
 & \textcircled{5} \frac{18'80 \times 9'40}{2} = 88'36 \text{ m}^2 \\
 & \textcircled{6} \frac{79'50 \times 1'50}{2} = 59'875 \text{ m}^2 \\
 & \hline
 & \text{Total} \\
 & \frac{1264'86}{2} = 632'43 \\
 & \hline
 & 1320'51
 \end{aligned}$$

8 11:200

