

c/ Santa Cristina

c/ Concordia

78 m²

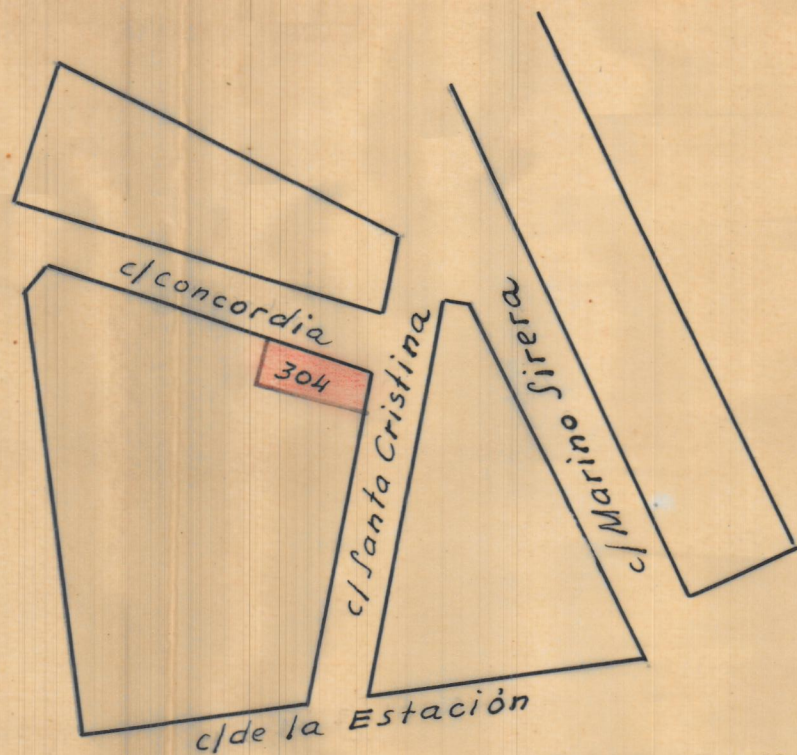

c/ de la Estación

c/ Santa Cristina

c/ Marino Sierra

c/ Concordia

304

ESCALA = 1:1000

ESCALA = 1:100

78
800

62400
005

3120'00
62400

66520
005

332600

Tarifa VII 0'5%

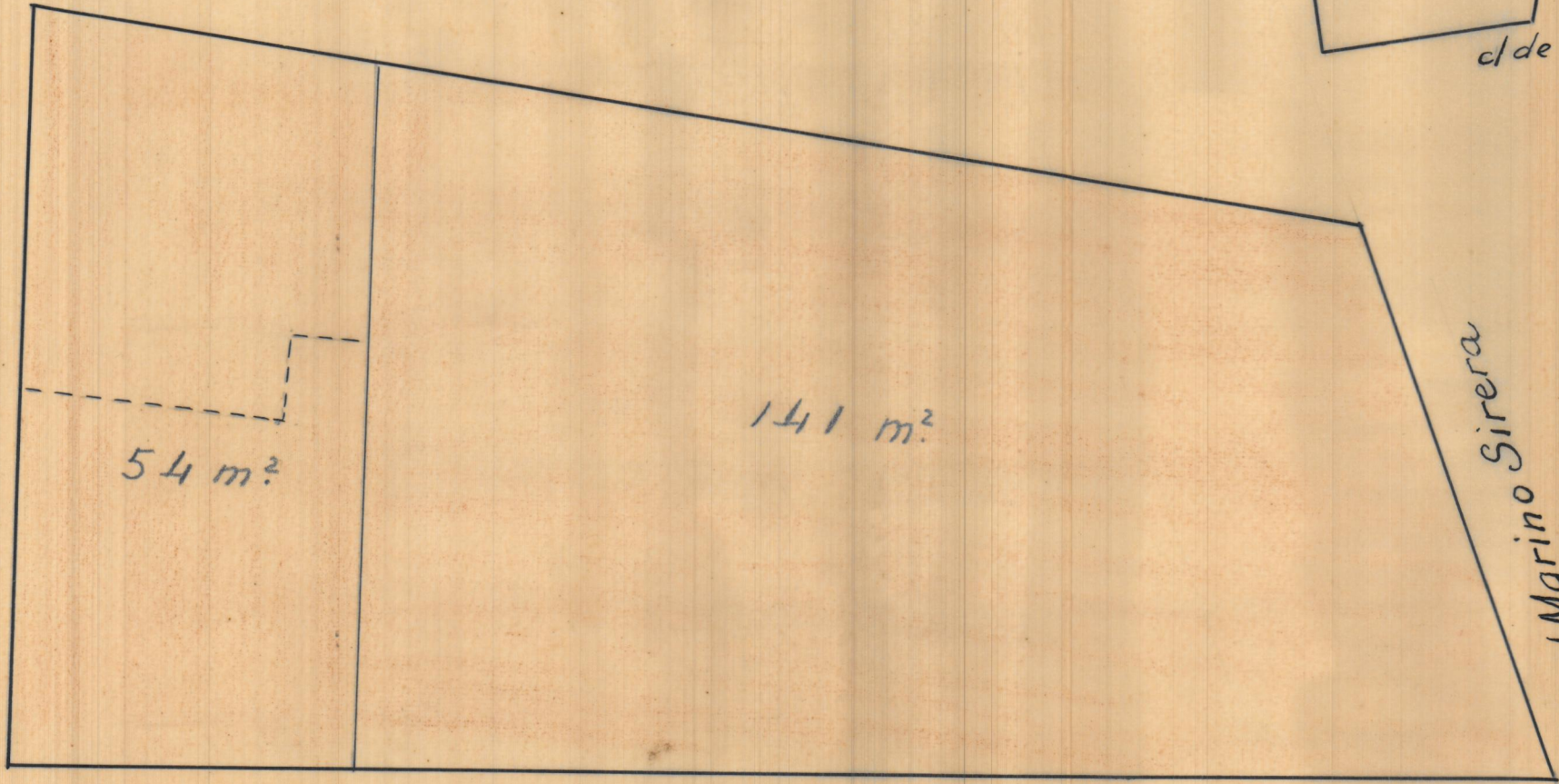

c/ de la Estación

ESCALA = 1:100

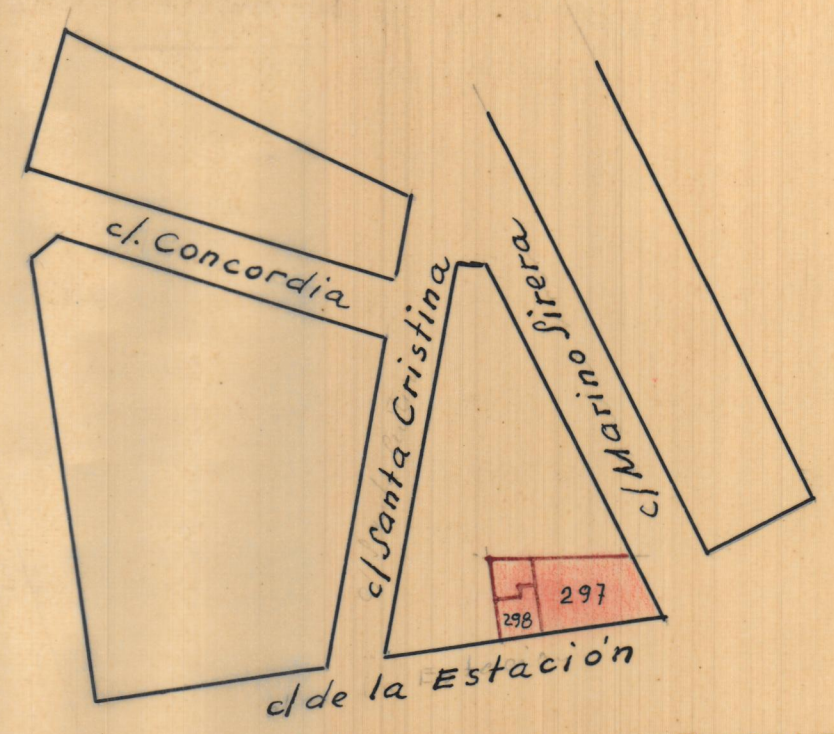

ESCALA = 1:1000

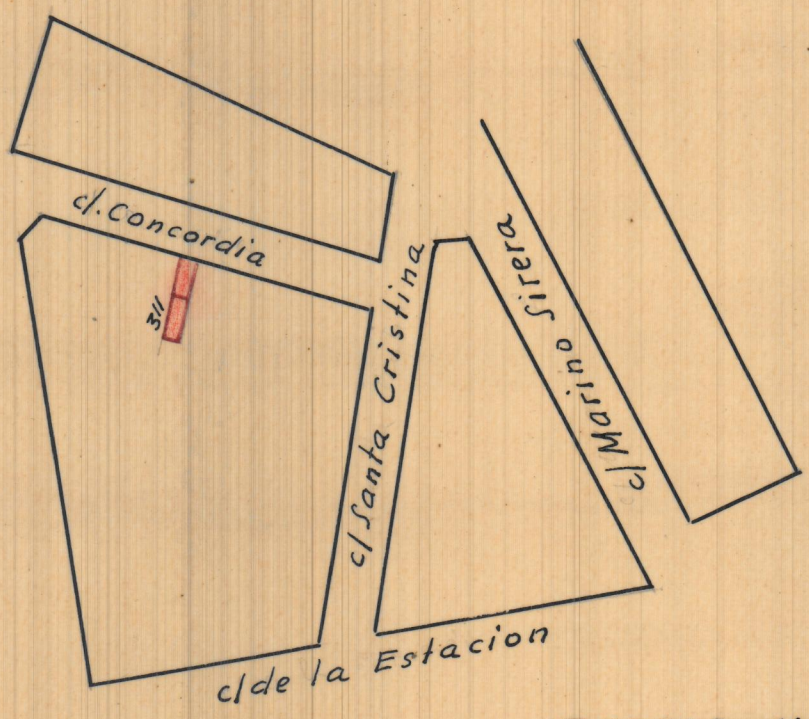

ESCALA = 1:1000

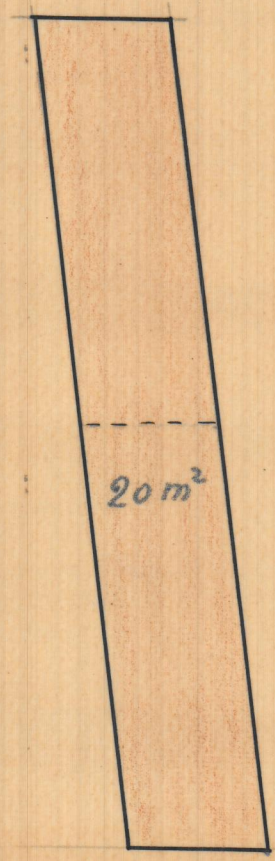

ESCALA = 1:100

c/Concordia

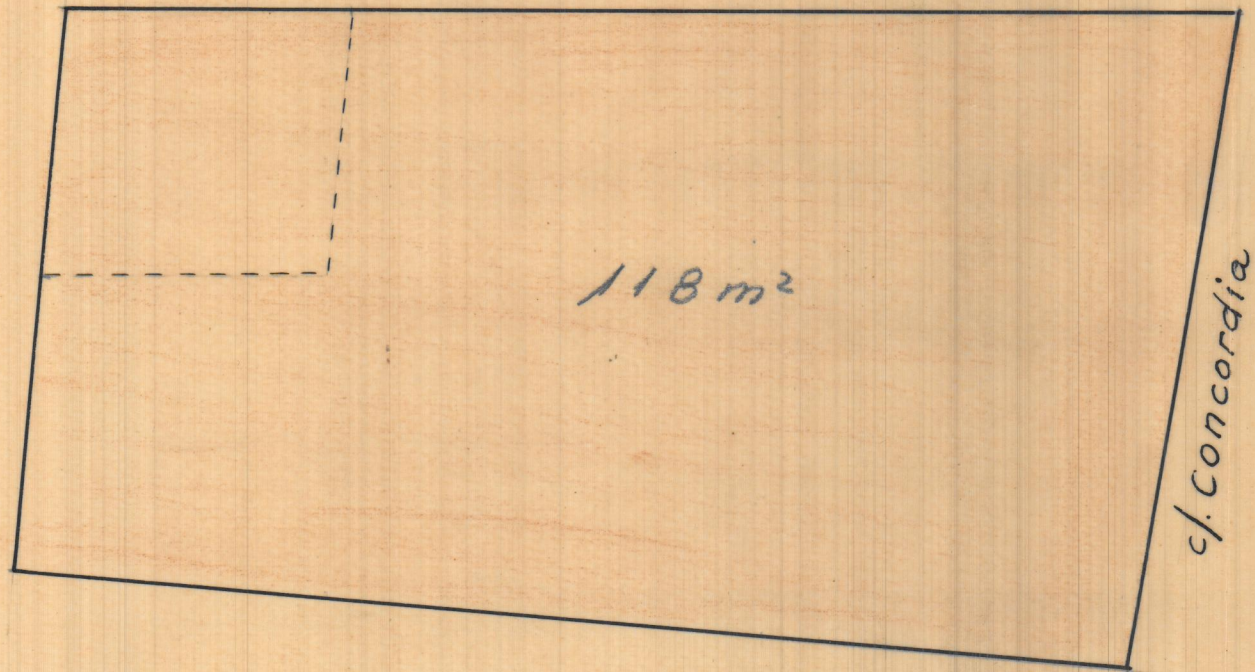

ESCALA = 1:100

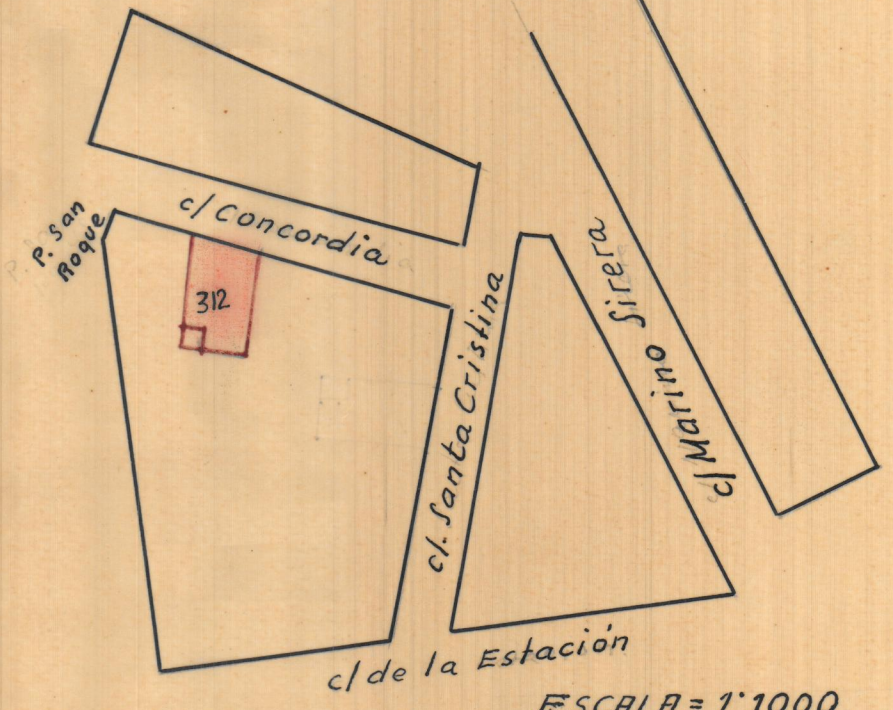

Herederos - D. GERMAN GARRIGOS

- 311 - Salva anexo - 20 m²
- 312 - Concordia 4 - 118 m²
- 313 - S. Roque 3 - 157'94 m²
- 304 - S. CRISTINA 4y6 - 78 m²
- 298 -
- 297 -

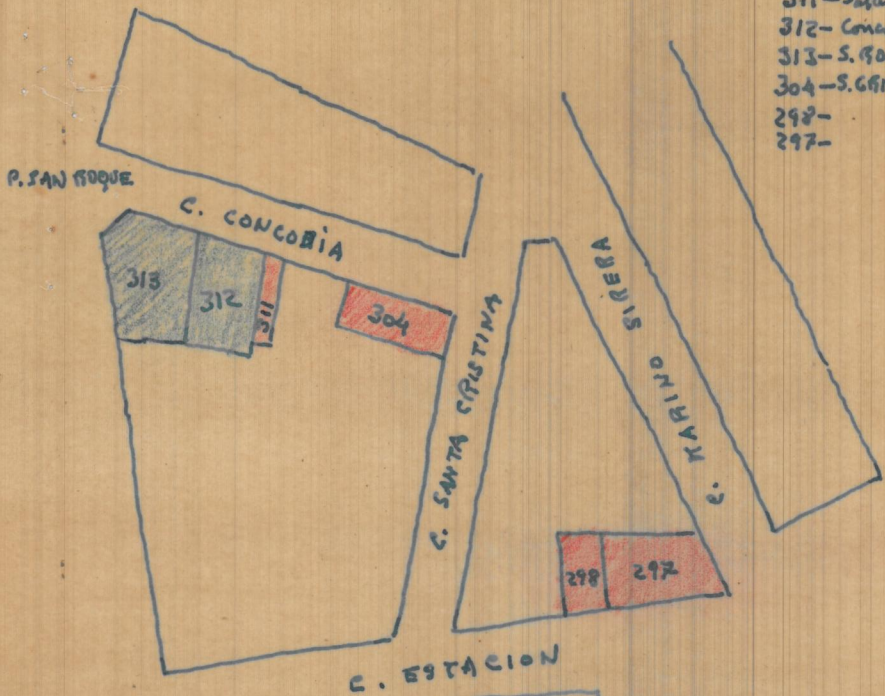

C. ESTACION

E.-1:1000